

# eArc

## SMF175M-5X07DW-e

# 175 Watt

## 35 Cell Monocrystalline Module

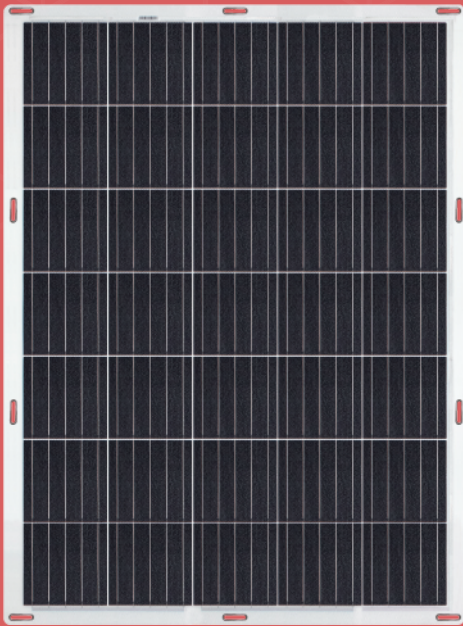

**Ultra-light:** Glass free module weighs 3.0 kg, 70% lighter than conventional glass modules.



**Aesthetic:** Seamless integration with underlying installation surface.



**Durable:** eArc is the first glassless module to pass the same durability tests as conventional glass modules, including IEC 61215:2016, IEC61730:2016 and UL1703 (USA). eArc has also passed PID, salt mist and ammonia corrosion tests.

POWER OUTPUT RANGE 175 W

POWER TOLERANCE 0-5 W

**12 Year Product Warranty**

**25 Year Linear Power Warranty**



[www.sunman-energy.com](http://www.sunman-energy.com)



ULTRA-LIGHT & FLEXIBLE SOLAR PANEL

### LINEAR PERFORMANCE WARRANTY

CAUTION: Read installation manual before using the product.

©2021 Sunman (zhenjiang) Co., Ltd. All rights reserved. Specifications included in this datasheet are subject to change without notice.

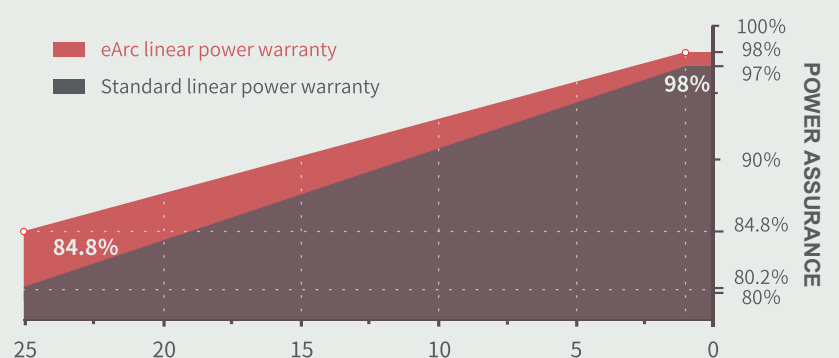

## DIMENSIONS

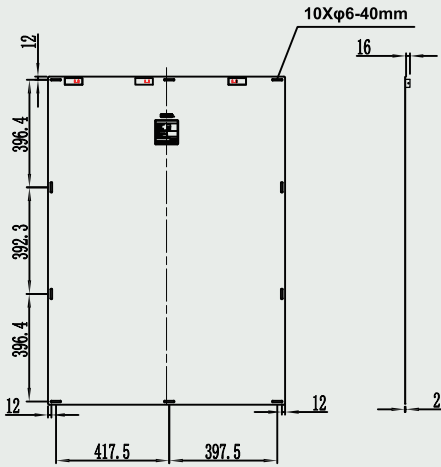

## I-V CURVE (185)

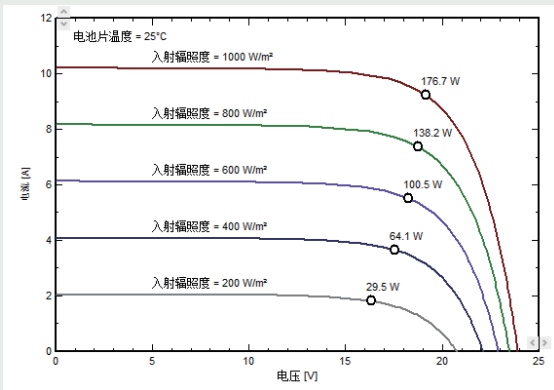

## TEMPERATURE CHARACTERISTICS

Nominal Module Operating Temperature(NMOT)	<b>41±2 °C</b>
Temperature Coefficient of $P_{max}$	<b>-0.38 %/°C</b>
Temperature Coefficient of $V_{oc}$	<b>-0.28 %/°C</b>
Temperature Coefficient of $I_{sc}$	<b>0.020 %/°C</b>

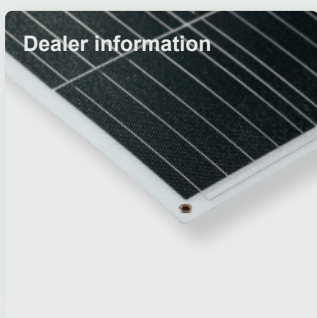

SMFDW/IEC EN 2022D

## ELECTRICAL CHARACTERISTICS

STC	SMF175M-5X07DW-e
Maximum Power ( $P_{max}$ )	175
Maximum Power Voltage ( $V_{mp}$ )	18.4
Maximum Power Current ( $I_{mp}$ )	9.54
Open-circuit Voltage ( $V_{oc}$ )	23.9
Short-circuit Current ( $I_{sc}$ )	10.21
Module Efficiency (%)	17.5
Operating Temperature	-40 °C to 85 °C
Maximum System Voltage	1000 V DC (IEC)
Maximum Series Fuse Rating	20 A
Application Class	Class A
Power Tolerance	0/+5 W

STC: Irradiance 1000W/m<sup>2</sup>, Cell temperature 25°C, AM=1.5.

Tolerances of  $P_{max}$ ,  $V_{oc}$  and  $I_{sc}$  are within ±5%

NMOT	SMF175M-5X07DW-e
Maximum Power ( $P_{max}$ )	141.2
Maximum Power Voltage ( $V_{mp}$ )	19.1
Maximum Power Current ( $I_{mp}$ )	7.39
Open-circuit Voltage ( $V_{oc}$ )	23.8
Short-circuit Current ( $I_{sc}$ )	8.16

NMOT: Irradiance 800W/m<sup>2</sup>, Ambient temperature 20°C, AM=1.5, Wind speed 1 m/s.

## MECHANICAL CHARACTERISTICS

Solar Cell	Monocrystalline silicon (158.75mm)
No. of Cells	35 (5×7)
Module Dimensions	1209×873×2 mm
Weight	3.0kg
Backsheet	White
Frame	Frameless
J-box	IP 68 rated
Output Cables	Photovoltaic technology cable 4.0 mm 2, (+)450 mm / (-)450 mm
Connector	MC4 compatible

## PACKAGING CONFIGURATION

	20' GP	40' HC
Module per pallet	66+75	66+10
Pieces per container	1128	2556